



---

## Priorclave details - model no PS/RSC/EH450D.

---

450L Electrically Heated Pass Through Rectangular Section Priorclave autoclave (includes cooling & automatic timed freesteaming) - Price does not include installation costs, which require a site visit and / or detailed drawings

**Priorclave Rectangular section double door autoclaves** are available in 400, 450 and 700 litre capacities with other sizes available on request. They are available either electrically or direct steam heated and feature a simple, two hand wheel or three hand wheel hinged door closure. All models are fitted with two non-tipping shelves and a range of stainless steel baskets, waste containers and loading trolleys are available to suit these autoclaves.

The autoclave is manufactured to fit through and be sealed to a wall enabling items either to be sterilised into or out of a sealed laboratory according to requirements. The sealing flange is fitted to the chamber to provide a short length of the unit on one side of the barrier wall and a longer section carrying all service connections (usually in the unrestricted area).

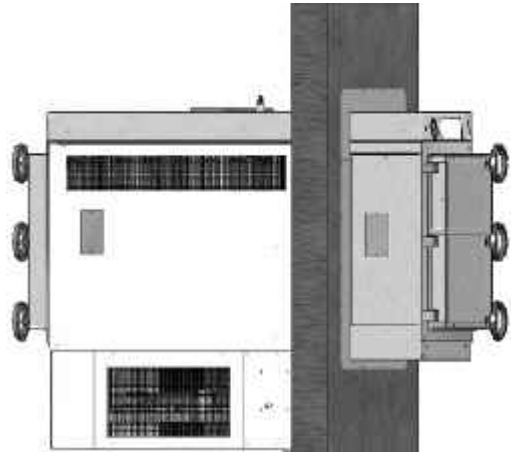

The following information will be required from the end users of the Priorclave, your Architect and your Mechanical and Electrical Consultants:

- A statement as to the items to be sterilised, the Hazard Group Classification of any waste to be sterilised and confirmation of the direction of flow of goods being sterilised through the Priorclave.
- A room drawing showing the two rooms to be bridged by the Priorclave, the thickness of the wall into which the Priorclave will be mounted, the method of construction of the wall and the desired position for the Priorclave.
- A separate drawing showing the provision of services for the Priorclave.

Where possible a site survey will be arranged to assist in specifying the requirements.

The doors are interlocked to prevent the opening of both doors at the same time.

A Control Panel is fitted to both ends of the Priorclave and if required a printer or recorder can be fitted to either end as required.

For more details on the issues around the specification and installation of double door autoclaves please refer to our data sheet: <http://www.priorclave.co.uk/downloads/DoubleEndDatasheet.pdf>

## Rectangular Section Priorclaves.

For those occasions when only 'square' will do! Perfect for high volume throughput as well as large or bulky items. These autoclaves combine a huge internal capacity with a small floor area and are ideally suited for use in a wide range of sterilising applications such as media preparation, liquids and diluent, waste, glassware, instruments, apparatus and health care.

They are extensively used within many industries, including food, drink, dairy, pharmaceutical, agricultural, education, healthcare, research establishments and industry.

### Features include:

- Capacities from 230 to 700 Litres and above. Intermediate sizes available to suit individual locations where required.
- Operation up to 140C - 2.5 Bar
- Large rectangular chamber within a compact frame
- Steam generated within the chamber (electrically heated models) - Direct steam heated models

available

- Complete with thermocouple entry and test ports
- Forced air cooling as standard helping to reduce cycle times
- Automatic timed freesteaming as standard for improved air removal and sterilising performance
- Delayed start and media warming function as standard for ready to pour media at the start of the day
- A large selection of options and accessories is available to help to get the most from your Priorclave autoclave
- Supplied with two full width non-tipping stainless steel shelves.
- Stainless steel baskets, waste containers and loading trolleys available

All models are fitted with the **TACTROL** microprocessor control system. After setting your required operating parameters press the start button for a fully automatic cycle. The control panel shows cycle status with digital readouts of temperature and time that can be viewed simultaneously. Temperature and time settings are fully adjustable within the operating range of the autoclave. Power door and double door (pass-through) versions are also available along with full steam/water jackets if required.

### Safety

Pressure vessels are fully **CE** marked and insurance approved to the European PED 97/23/EC. The autoclaves fully conform to BS2646-1993, BS5500 Cat.3, and EMC directives, amongst others. All autoclave doors are fully interlocked for safety with a special safety handwheel mechanism, which cracks the gasket seal allowing any residual pressure to safely escape. A thermal cooling lock, preventing the door from being opened until the contents have cooled to a safe temperature is also fitted along with a pressure interlock.

A safety blow down valve and a low water level sensor to guard against boil-dry conditions (electrically heated models) afford further protection.

Epoxy coated panels and frame members are treated with the unique **Biocote** anti-bacterial agent, which is effective against all bacteria and fungi including MRSA.

### Installation Requirements

**Electrical:** 3 Phase – 400V, 21kW, 30A (230, 285 & 350L Models), 400V, 32.5kW, 60A (450L Model), 400V, 42kW, 60A (700L Model)

**Steam:** (Direct steam heated models only): - Dry Steam reduced to 40psi. ½ in BSP.

**Drainage:** - The single 1 in vent outlet pipe can be directed to a nearby drain. For make safe processing the discharge should be directed to a sealed discharge system; the system should lead by direct connection to a building drain or catchment tank.

For more specific advice about your particular installation requirements please contact our Technical Department or download our data sheet outlining the installation requirements for Priorclaves or any other type of Laboratory autoclave at: <http://www.priorclave.co.uk/downloads/installation.PDF>

Rectangular Section Priorclave autoclaves have a 12 months parts and labour warranty (parts only outside the UK) and a 10 year or 8,000 cycle pressure vessel warranty.

---

## Technical Specifications.

---

**Max. Capacity:** 450L

**Internal Diameter:** -mm

**Load height:** 800mm

<b>Dimensions (mm)</b>	<b>Width</b>	<b>Depth</b>	<b>Height</b>	<b>Packed Dimensions (mm)</b>	<b>Width</b>	<b>Depth</b>	<b>Height</b>
<b>Internal</b>	675	900	755	<b>UK Delivery</b>	-	-	-
<b>External</b>	-	-	-	<b>Delivery by Sea</b>	-	-	-
<b>Installed</b>	-	-	-	<b>Delivery by Air</b>	-	-	-

<b>Weights (Kg)</b>	
<b>Gross</b>	-
<b>Packed (Sea)</b>	-
<b>Packed (Air)</b>	-

**NB:** Weights and dimensions shown are for the Autoclave only, unloaded and without water (if applicable). These figures do not include any options and accessories listed below which may alter external dimensions and weights. For full details please contact Priorclave or your local agent.

## Options & Accessories.

<b>Recommended</b>	
<b>Code</b>	<b>Description</b>
<b>PC/VPC/400</b>	Combined pre-cycle vacuum and vacuum cooling - Rectangular 450/700
<b>PC/VPD/400</b>	Post cycle vacuum drying option - Rectangular 450/700
<b>PC/HOS/000</b>	Hospital Equipment Kit (C14/HTM2010)
<b>PC/INT/000</b>	Air Intake Filter System
<b>PC/HOS/010</b>	Hospital Specification Kit for Porous loads includes: test port on press. Gauge; mech. Cycle counter; back up t/stat for thermal lock; air detector; auto. Leak rate test; Bowie & Dick Test; Tactrol self-monitoring system
<b>PC/AVS/000</b>	Autoclave Performance Testing Service
<b>PC/ABC/000</b>	<b><u>Air Ballast System</u></b> Enables the use of sealed or semi-rigid containers and the autoclaving of, for example, contact lenses and liquids or gels in pouches without distortion of the containers during cooling. It is also required to prevent container breakage and volume losses during cooling on autoclaves cooled by an external water jacket when autoclaving any liquid loads. Includes a 0.2 micron filter, a pressure regulator, oil and water traps and two pressure gauges. Requires an external dry, oil free air supply, terminated at a suitable isolating connector within 2 meters of the rear of the autoclave.
<b>PC/INS/ZNA</b>	Installation - Compact, Standard & RSC Units - Zone A
<b>PC/RSC/DIL</b>	Stainless Steel Discard Container for RSC 450 & 700L Model Priorclaves. Important for autoclaving waste loads to contain spillage and to protect the inside of the autoclave from damage.
<b>PC/PFS/000</b>	Pulsed Freesteaming
<b>PC/PRG/TAC</b>	TACTROL 5 Program Memory
<b>Code</b>	<b>Description</b>
<b>PC/LPT/000</b>	Load Sensed Process Timing
<b>PC/PRN/000</b>	Priorclave Tactrol Printer
<b>Code</b>	<b>Description</b>
<b>PC/PRN/010</b>	Load Temperature Indication (included if Loadsense is fitted)
<b>PC/AWF/RSC</b>	Automatic Waterfill System for RSC Priorclaves
<b>PC/BA1/RSC</b>	Stainless steel mesh baskets for RSC 450 & 700. 650x290x190mm (wxdxh)
<b>PC/DRC/020</b>	Heat exchange condenser (28mm / 1" BSP) for RSC Models
<b>PC/LOC/000</b>	Setting Lock Keyswitch Facility
<b>PC/P10/TAC</b>	TACTROL 10 Program Memory
<b>PC/PRN/020</b>	Pressure Printout
<b>PC/SPK/RH2</b>	Spares Kit 2 Years RSC Priorclaves
<b>PC/SPK/RH3</b>	Spares Kit 3 Years RSC Priorclaves
<b>PC/WSC/000</b>	Scale Prevention System-small
<b>PC/WSC/010</b>	Scale Prevention System-large
<b>Code</b>	<b>Description</b>
<b>PC/MED/000</b>	Media Warming Facility
<b>PC/TFS/000</b>	Automatic Timed Freesteaming